

PROKARYOTIC CELLS.

CELL MEMBRANE_A
 PILUS_{A'}
 CELL WALL_B
 OUTER MEMBRANE_C
 CAPSULE_D
 FLAGELLUM_E
 NUCLEOID_F
 PLASMID_{F'}

CYTOPLASM_G
 RIBOSOME_G
 MESOSOME_H
 PHYCOBILISOME_I
 THYLAKOID MEMBRANE_J
 THYLAKOID COMPARTMENT_K
 HYALOPLASM_L

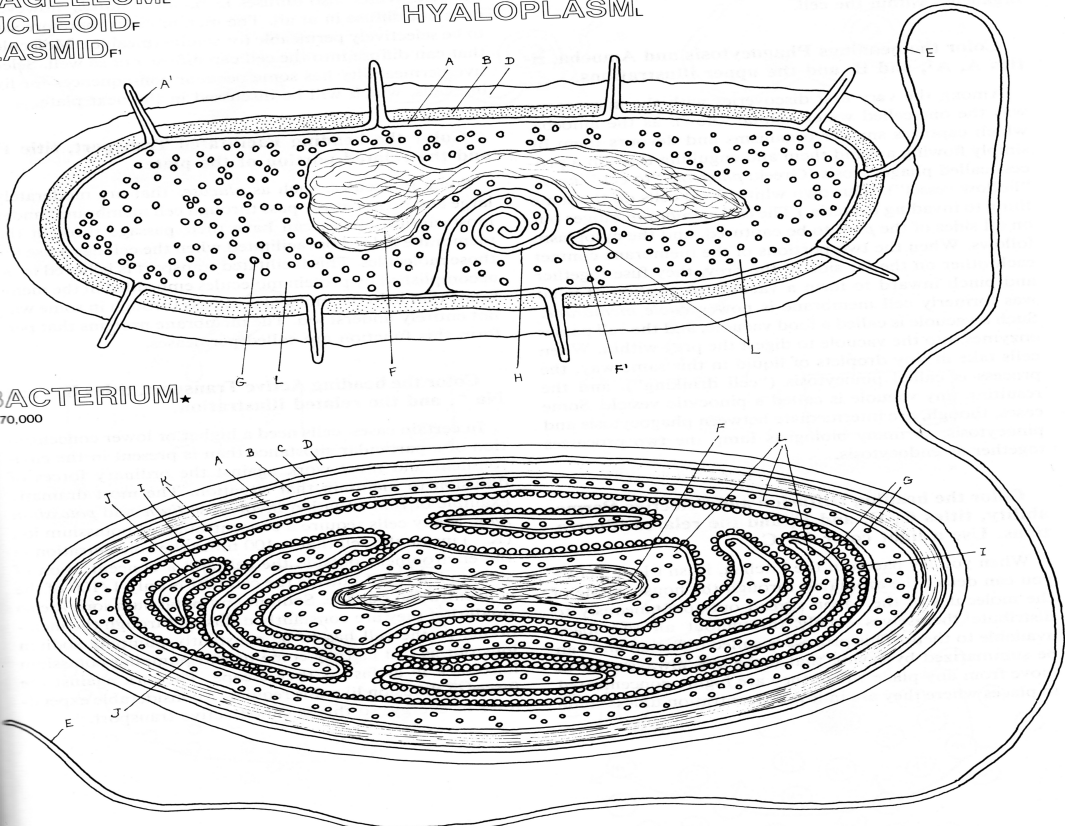

BACTERIUM*
x 70,000

CYANOPHYTE*
x 70,000

JAY KEIMER